

Dry-Shield® 2 Gang Box 3 Hole Threaded Outlets

Features

- Durable die-cast aluminum construction provides a long product life.
- 1/2", 3/4" and 1" NPT threaded Outlets.
- Precision cast and machined surfaces allow safer wire-pulling.
- Mounting lugs for a variety of mounting methods.
- Available in gray, black, bronze and white.

Applications

- For use as a weatherproof junction box in damp or wet locations when combined with a weatherproof cover.
- Features an accessible wiring chamber that provides a convenient location to maintain or change a system, make splices, and pull conductors.
- Junction box to branch conduits.

Standard Material

- Die Cast Aluminum

Standard Finish

- Powder Coated

Packaging

- Shrink Packed
- Blister Carded



Certification

- cULus Listed (E520149)
- Boxes and covers suitable for use in wet locations
- NEMA 3R Rated
- Complies with NEC Article 409.6(B)(1)

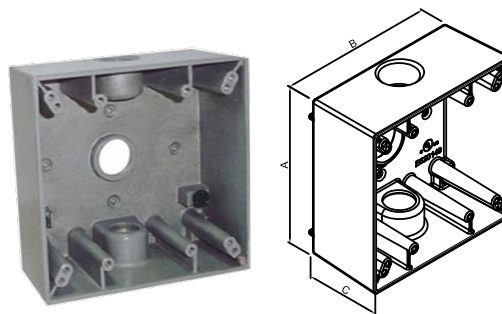

Catalog ID	Size	Outlet	A	B	C	Volume In³	Color
W2B503	1/2	3-1/2	4.50	4.50	2.10	30	Gray
W2B503BL	1/2	3-1/2	4.50	4.50	2.10	30	Black
W2B503AB	1/2	3-1/2	4.50	4.50	2.10	30	Bronze
W2B503WH	1/2	3-1/2	4.50	4.50	2.10	30	White
W2B753	3/4	3-3/4	4.50	4.50	2.10	30	Gray
W2B753BL	3/4	3-3/4	4.50	4.50	2.10	30	Black
W2B753AB	3/4	3-3/4	4.50	4.50	2.10	30	Bronze
W2B753WH	3/4	3-3/4	4.50	4.50	2.10	30	White
W2B1003	1	3-1	4.50	4.50	2.10	31	Gray
W2B1003BL	1	3-1	4.50	4.50	2.10	31	Black
W2B1003AB	1	3-1	4.50	4.50	2.10	31	Bronze
W2B1003WH	1	3-1	4.50	4.50	2.10	31	White

Dry-Shield® 2 Gang Box 3 Hole Threaded Outlets (Universal)

Features

- Durable die-cast aluminum construction provides a long product life.
- 1/2" and 3/4" NPT threaded Outlets.
- Precision cast and machined surfaces allow safer wire-pulling.
- Mounting lugs for a variety of mounting methods.
- Available in gray, black, bronze and white.

Applications

- For use as a weatherproof junction box in damp or wet locations when combined with a weatherproof cover.
- Features an accessible wiring chamber that provides a convenient location to maintain or change a system, make splices, and pull conductors.
- Junction box to branch conduits.

Standard Material

- Die Cast Aluminum

Standard Finish

- Powder Coated

Packaging

- Shrink Packed
- Blister Carded



Certification

- cULus Listed (E520149)
- Boxes and covers suitable for use in wet locations
- NEMA 3R Rated
- Complies with NEC Article 409.6(B)(1)

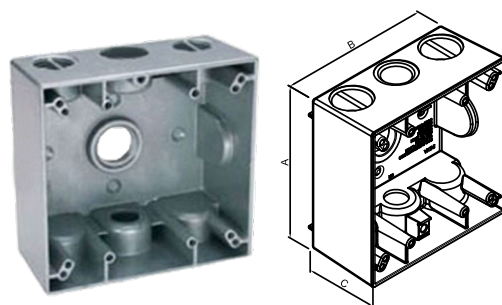

Catalog ID	Size	Outlet	A	B	C	Volume In³	Color
W2B503U	1/2	3-1/2	4.50	4.50	2.10	30	Gray
W2B503UBL	1/2	3-1/2	4.50	4.50	2.10	30	Black
W2B503UAB	1/2	3-1/2	4.50	4.50	2.10	30	Bronze
W2B503UWH	1/2	3-1/2	4.50	4.50	2.10	30	White
W2B753U	3/4	3-3/4	4.50	4.50	2.10	30	Gray
W2B753UBL	3/4	3-3/4	4.50	4.50	2.10	30	Black
W2B753UAB	3/4	3-3/4	4.50	4.50	2.10	30	Bronze
W2B753UWH	3/4	3-3/4	4.50	4.50	2.10	30	White